

XM

31st JULY 1995

REF.

4

No XM 312-1/5

ABONNEMENT GME

CLUTCH

- REMOVING - REFITTING:
"Pull-type" clutch, DK5 engine -
MG5TB gearbox

[dA]

[dA]



MAN 058931



1



AUTOMOBILES CITROËN
DIRECTION COMMERCE EUROPE
DOCUMENTATION APRÈS VENTE

(GB)

REMOVING – REFITTING : "PULL-TYPE" CLUTCH, ENGINE DK5 – MG5TB GEARBOX

1 – RECOMMENDED TOOLS

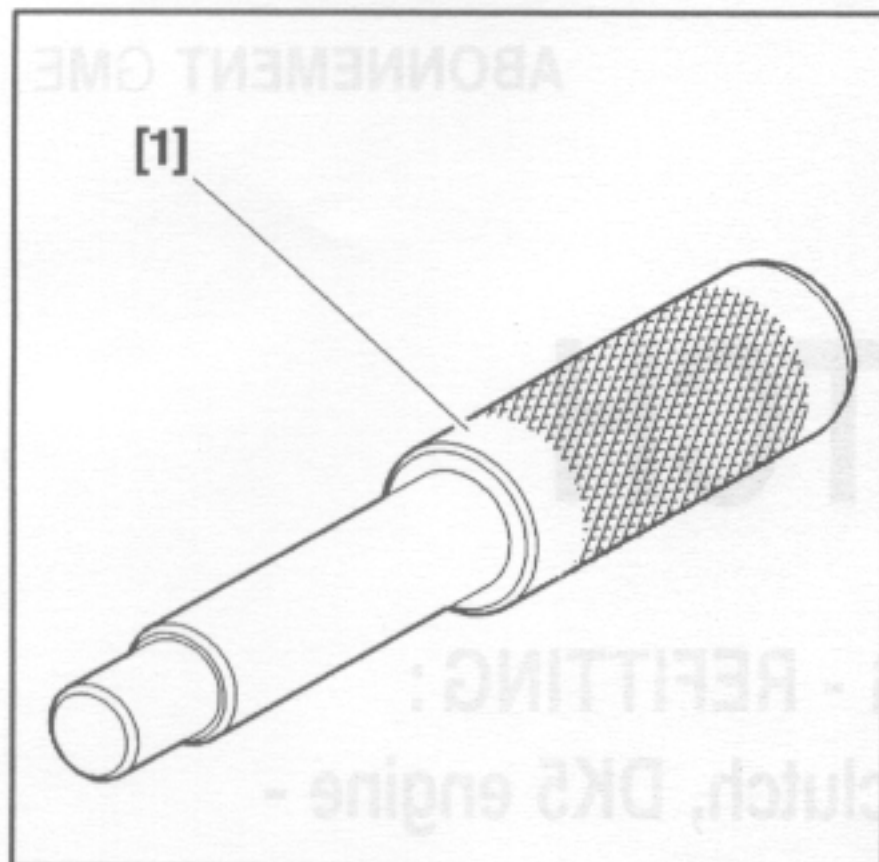

Fig : E5-P054C

[1] clutch centring mandrel 5712-T.

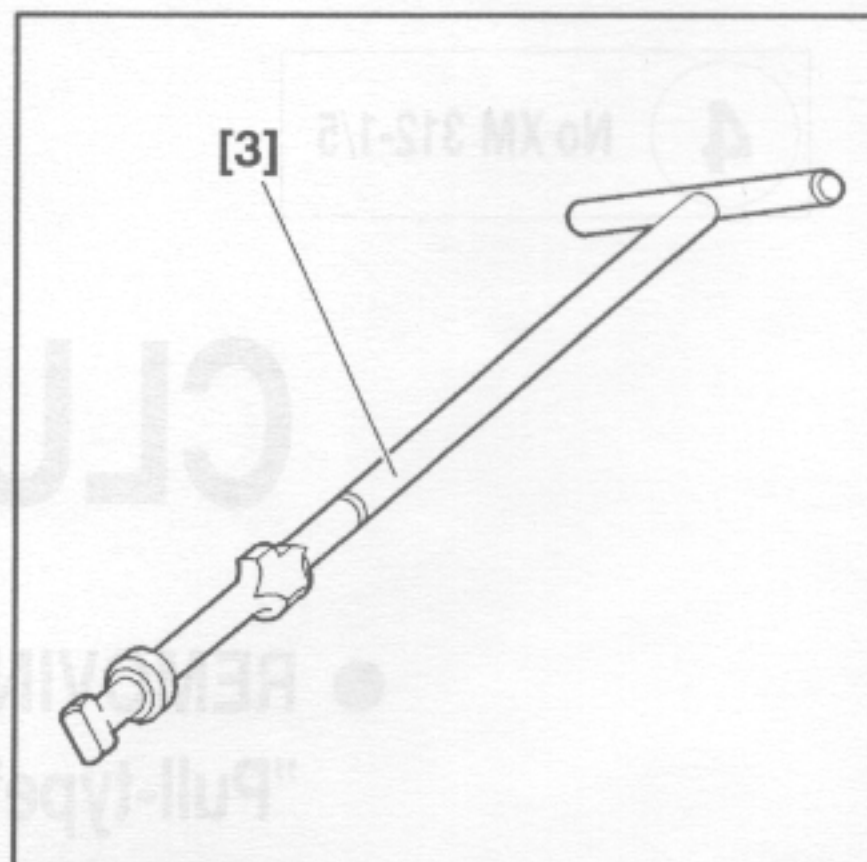

Fig : E5-P056C

[3] tool for clipping the clutch thrust bearing 9040-T.E.

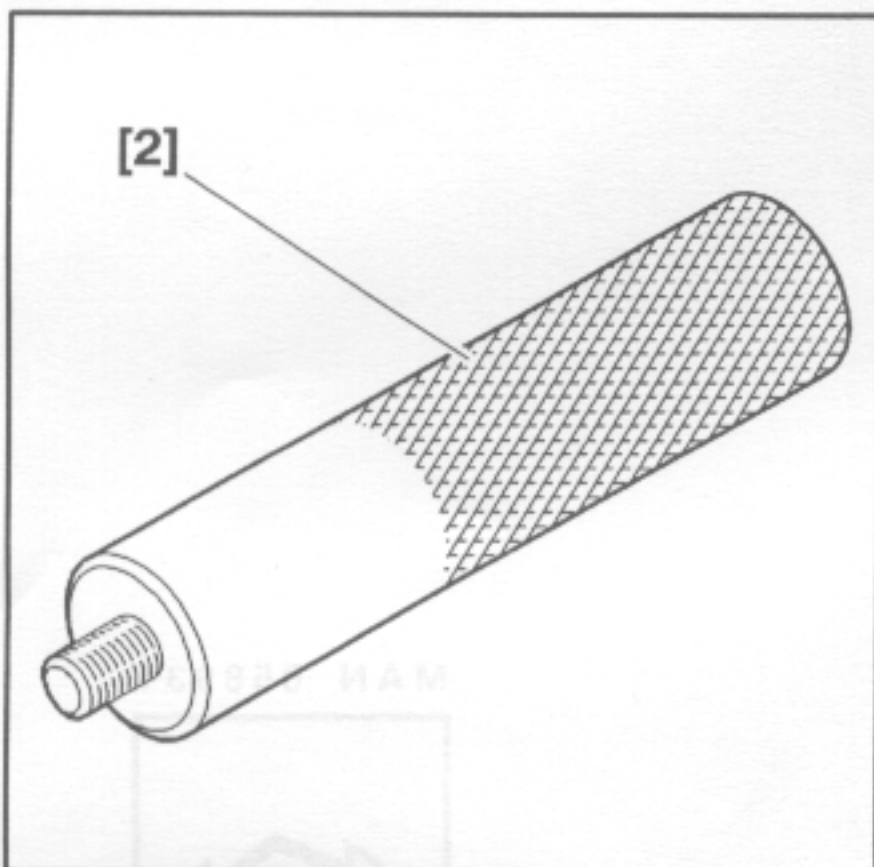

Fig : E5-P055C

[2] clutch fork spindle removing-refitting tool (5708-T.G).

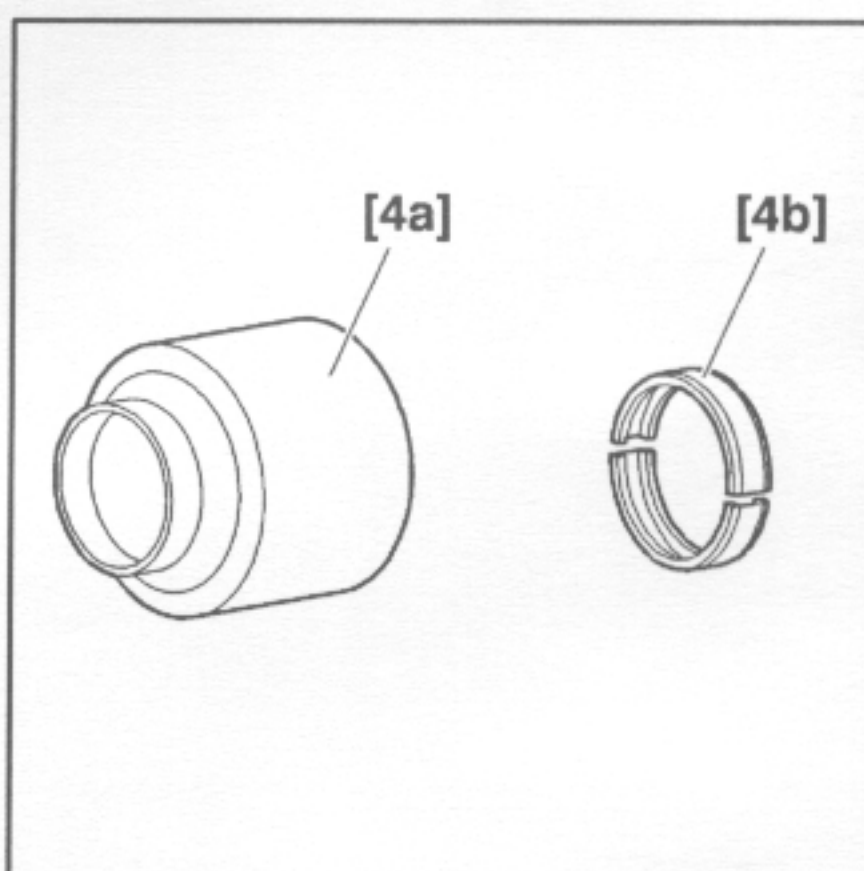

Fig : E5-P057C

[4a-4b] tool for unclipping the clutch thrust bearing 9040-T.D1 + 9040-T.D2.

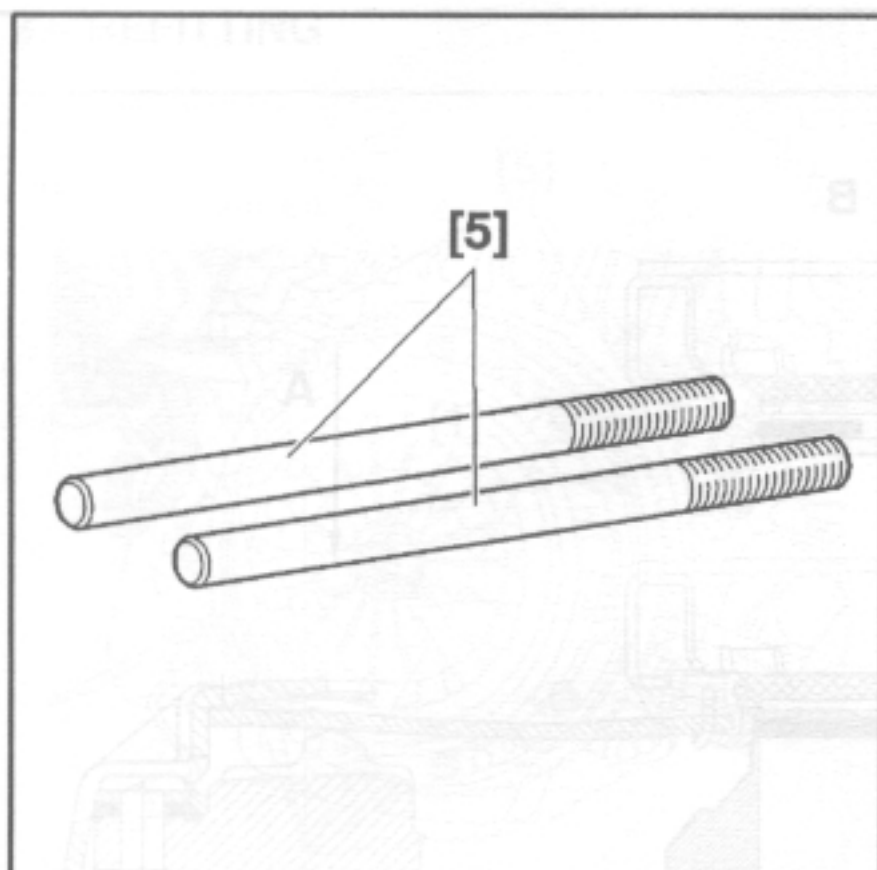

Fig : E5-P058C

[5] engine/gearbox centring guide pins (9040-T.A).

2 - REMOVAL

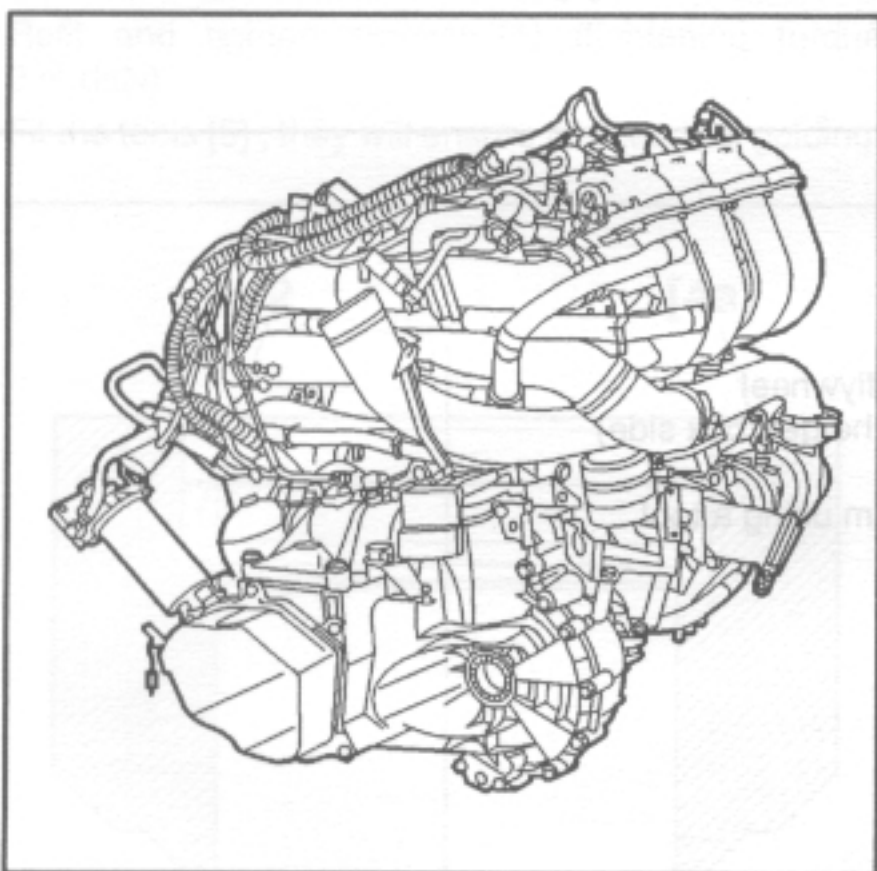

Fig : B2CP072C

Remove the power unit assembly (see the relevant operation).

Remove the gearbox (see the relevant operation).

Fig : B2BP01AC

ATTENTION : Before removing the clutch thrust bearing, bush (2) must be inserted on the circlip.

Remove the circlip.

Remove bush (2).

Introduce bush (2) into tool [4a].

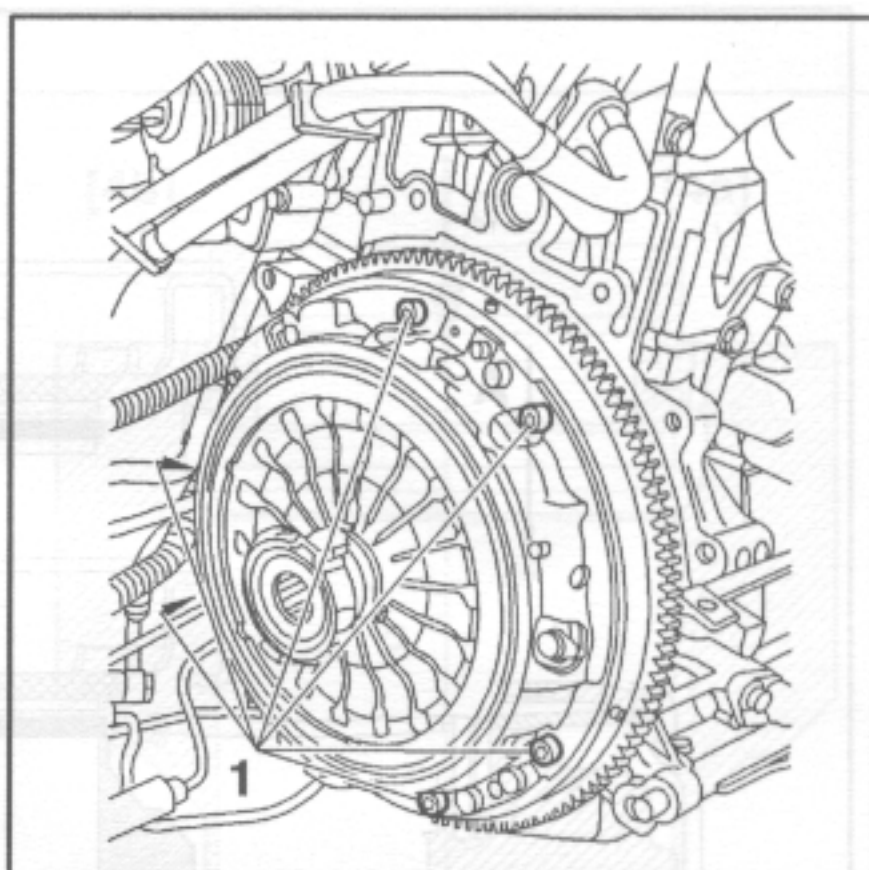

Fig : B2BP01AC

Remove :

- screws (1)
- the clutch mechanism together with the clutch thrust bearing
- the clutch disc

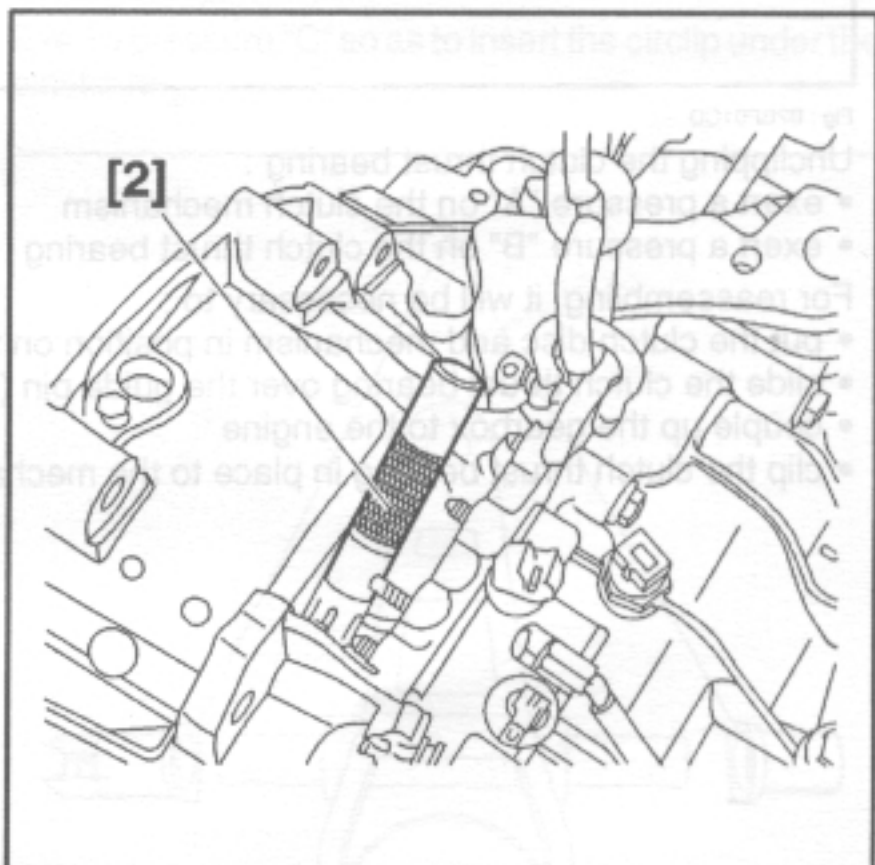

Fig : B2BP01BC

Remove :

- the clutch fork shaft, utilising tool [2]
- the clutch fork

ATTENTION : If the clutch components are to be re-used, it is necessary to separate the clutch thrust bearing from the clutch mechanism, utilising tool [4a].

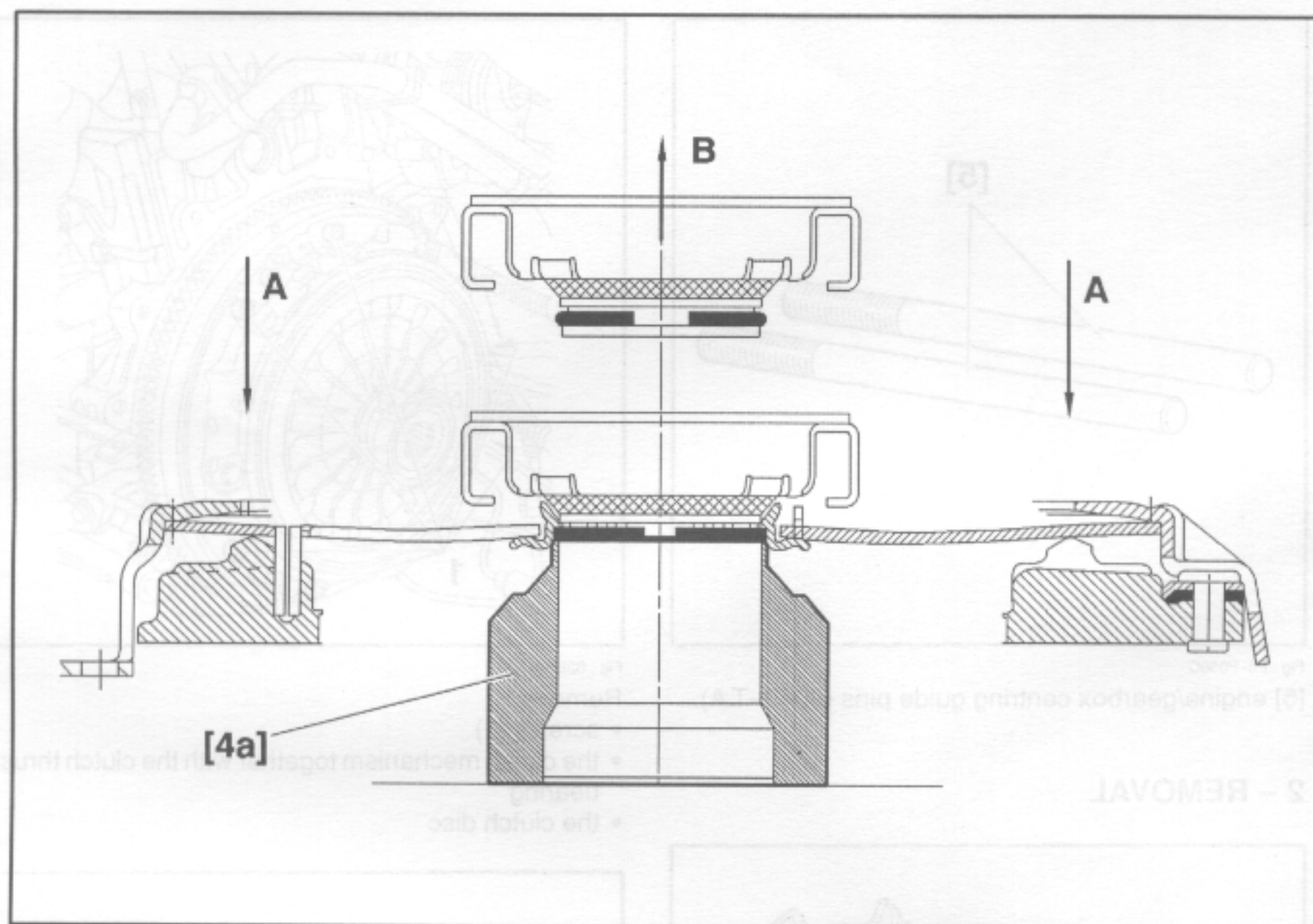

Fig : B2BP01CD

Unclipping the clutch thrust bearing :

- exert a pressure "A" on the clutch mechanism
- exert a pressure "B" on the clutch thrust bearing

For reassembling, it will be necessary to :

- put the clutch disc and mechanism in position on the flywheel
- slide the clutch thrust bearing over the guide pin (on the gearbox side)
- couple up the gearbox to the engine
- clip the clutch thrust bearing in place to the mechanism using a tool

ATTENTION : If the clutch components are to be re-used, it is necessary to separate the clutch thrust bearing from the clutch mechanism, utilizing tool [4a].

3 – REFITTING

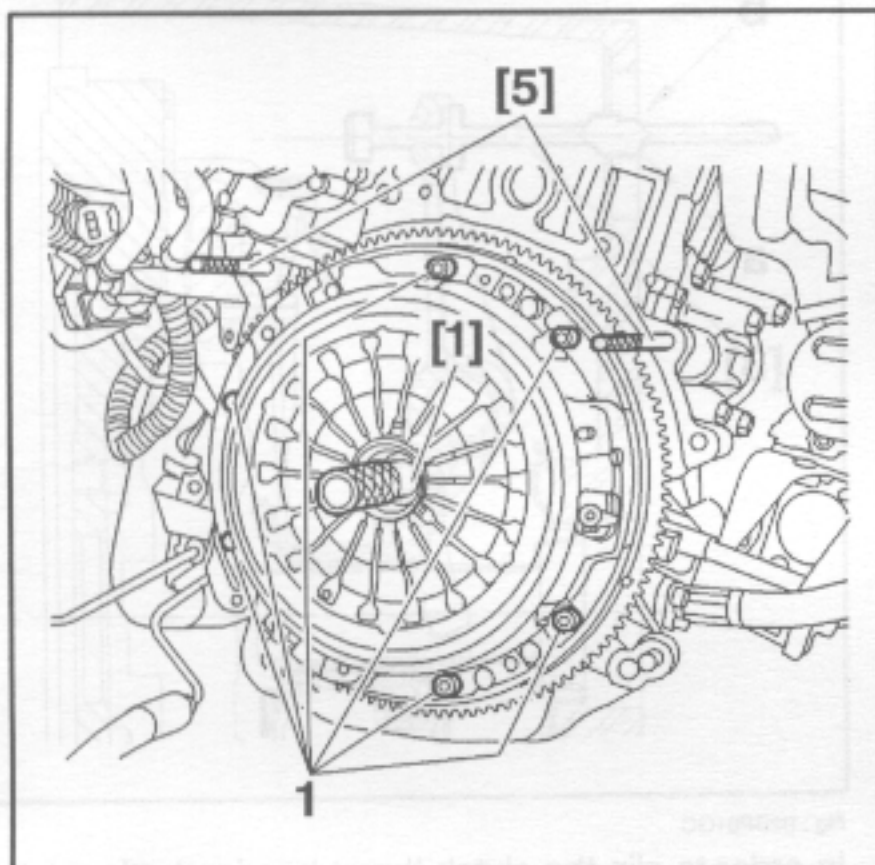

Fig : B2BP01DC

Put the clutch disc and mechanism in position on the flywheel.

Centre the disc by means of tool [1].

Refit and tighten screws (1) (tightening torque 2 m.daN).

Fit the tools [5] ; they will ensure the gearbox guiding.

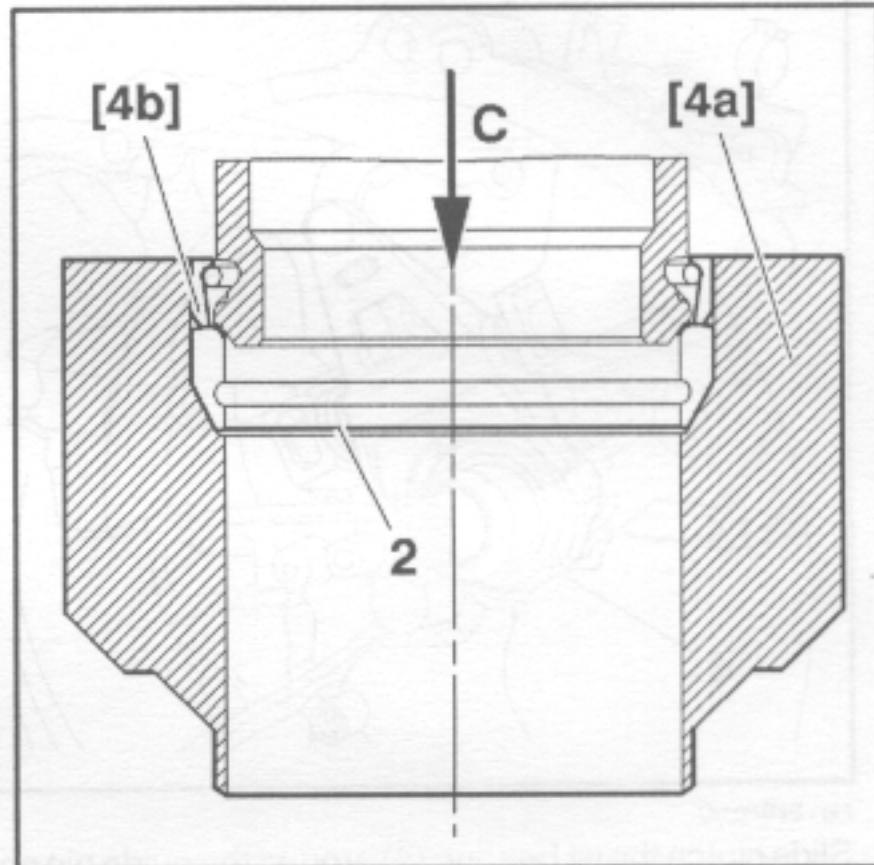

Fig : B2BP01FC

Fit the circlip to the clutch thrust bearing.

Place half-shells [4b] over the circlip and introduce the assembly into tool [4a] (fitting direction : chamfer downwards).

Exert a pressure "C" so as to insert the circlip under the plastic ring.

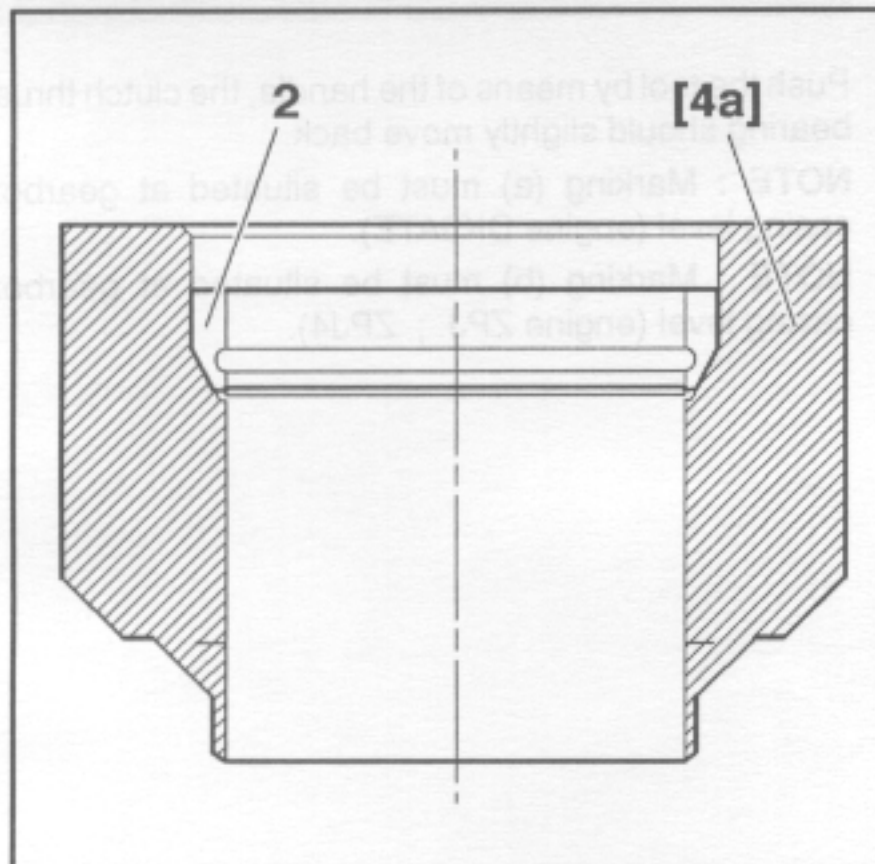

Fig : B2BP01EC

ATTENTION : To re-use the clutch thrust bearing, plastic bush (2) must be relocated on the circlip.

Remove the circlip.

Remove plastic bush.

Introduce plastic bush (2) into tool [4a].

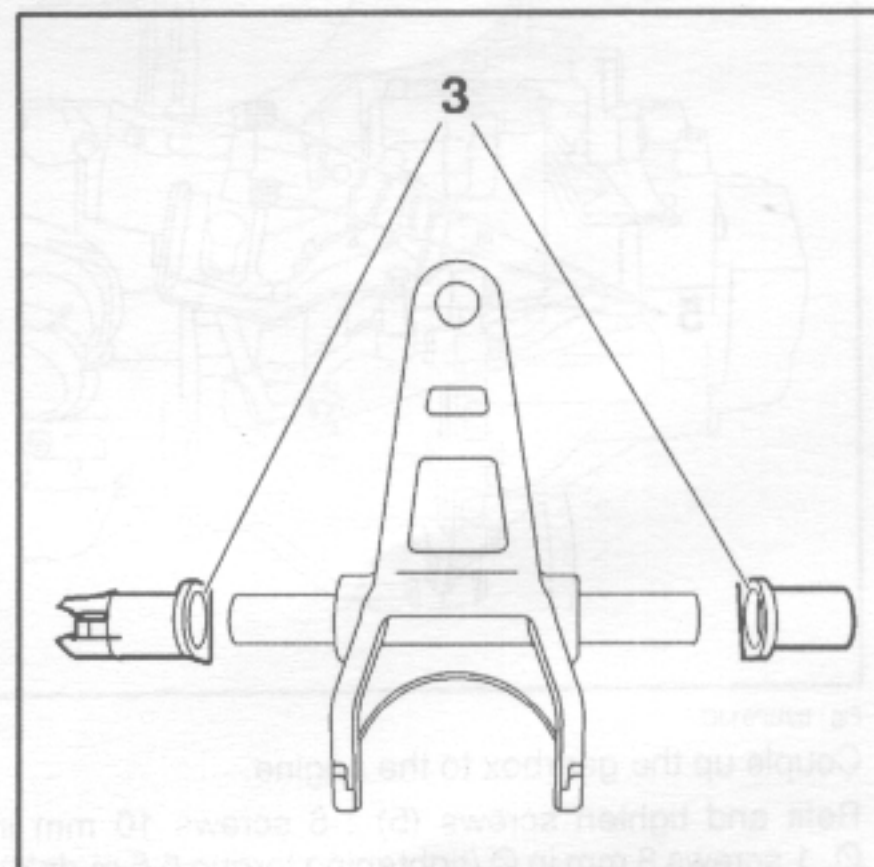

Fig : B2BP01HC

Replace fork shaft bearings (3) ; use new bearings.

Fit the clutch fork.

Lock the clutch fork, introducing its spindle.

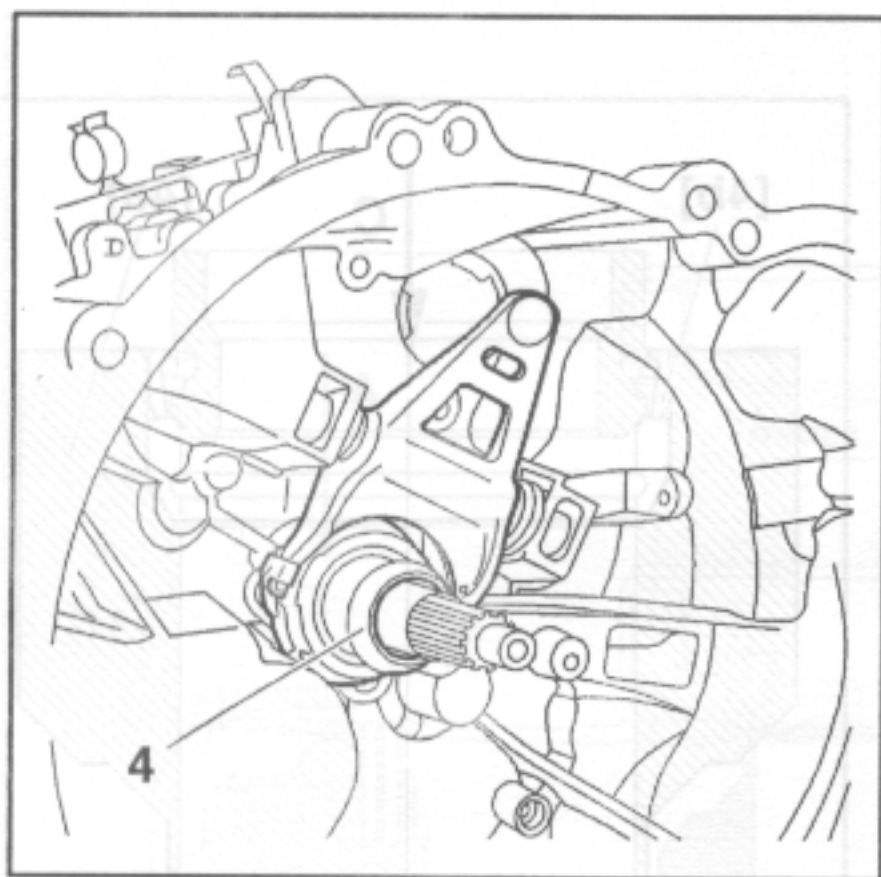

Fig : B2BP01IC

Slide clutch thrust bearing (4) around the guide pin and engage the clutch fork simultaneously.

Grease the thrust bearing guide and both ends of the clutch fork moderately with MOLYKOTE grease.

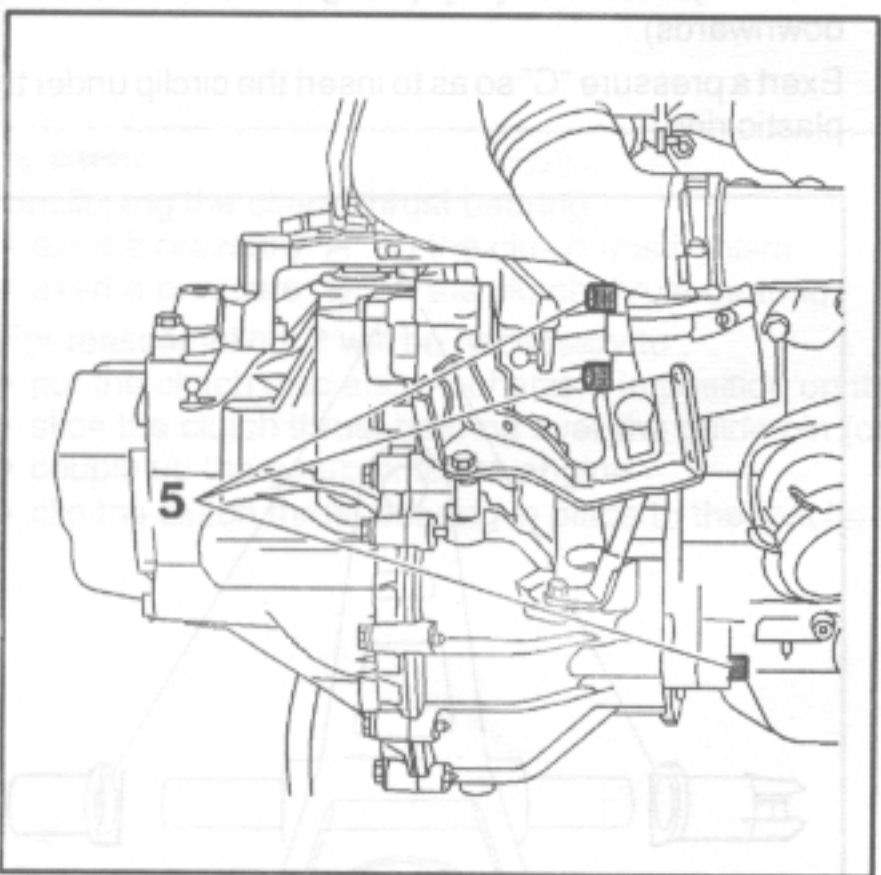

Fig : B2BP01JC

Couple up the gearbox to the engine.

Refit and tighten screws (5) : 6 screws 10 mm in Ø, 1 screws 8 mm in Ø (tightening torque 5.5 m.daN).

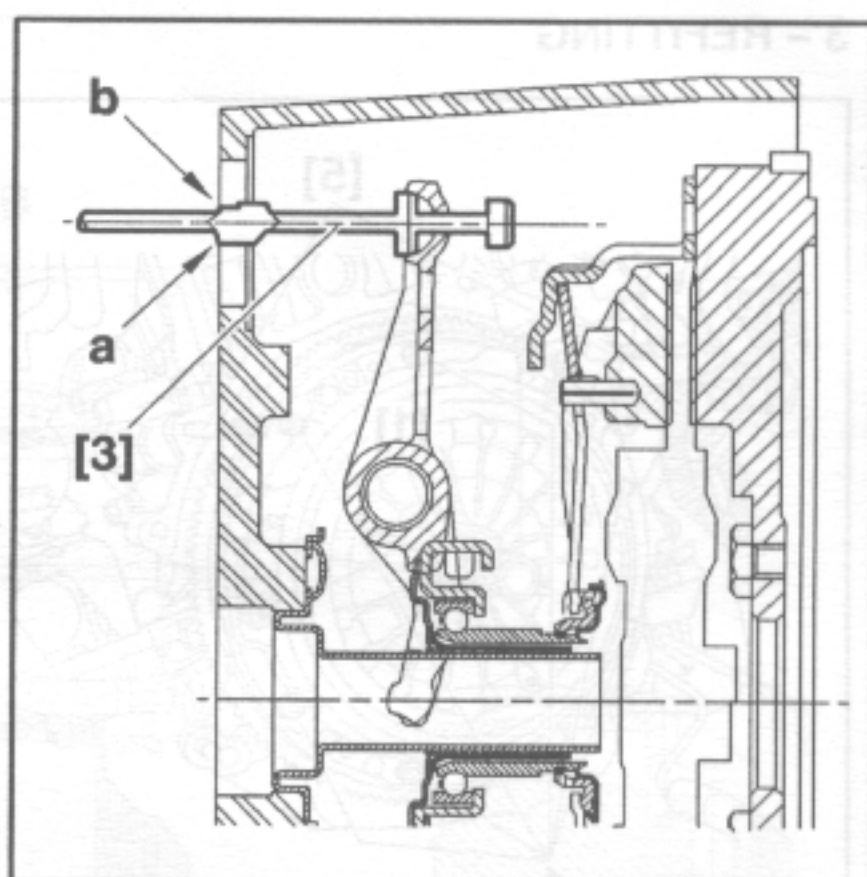

Fig : B2BP01GC

In order to clip the clutch thrust bearing to the clutch mechanism, it is necessary to :

- introduce tool [3] into the oblong hole of the clutch fork
- rotate the tool through 90 °
- pull the handle

IMPERATIVE : Ensure that the clutch thrust bearing is correctly attached to the clutch mechanism.

Push the tool by means of the handle, the clutch thrust bearing should slightly move back.

NOTE : Marking (a) must be situated at gearbox casing level (engine DK5ATE).

NOTE : Marking (b) must be situated at gearbox casing level (engine ZPJ ; ZPJ4).

ATTENTION : To re-use the clutch thrust bearing, plastic bush (2) must be relocated on the clip.

3.1 – Details of the clipping of the clutch thrust bearing to the clutch mechanism

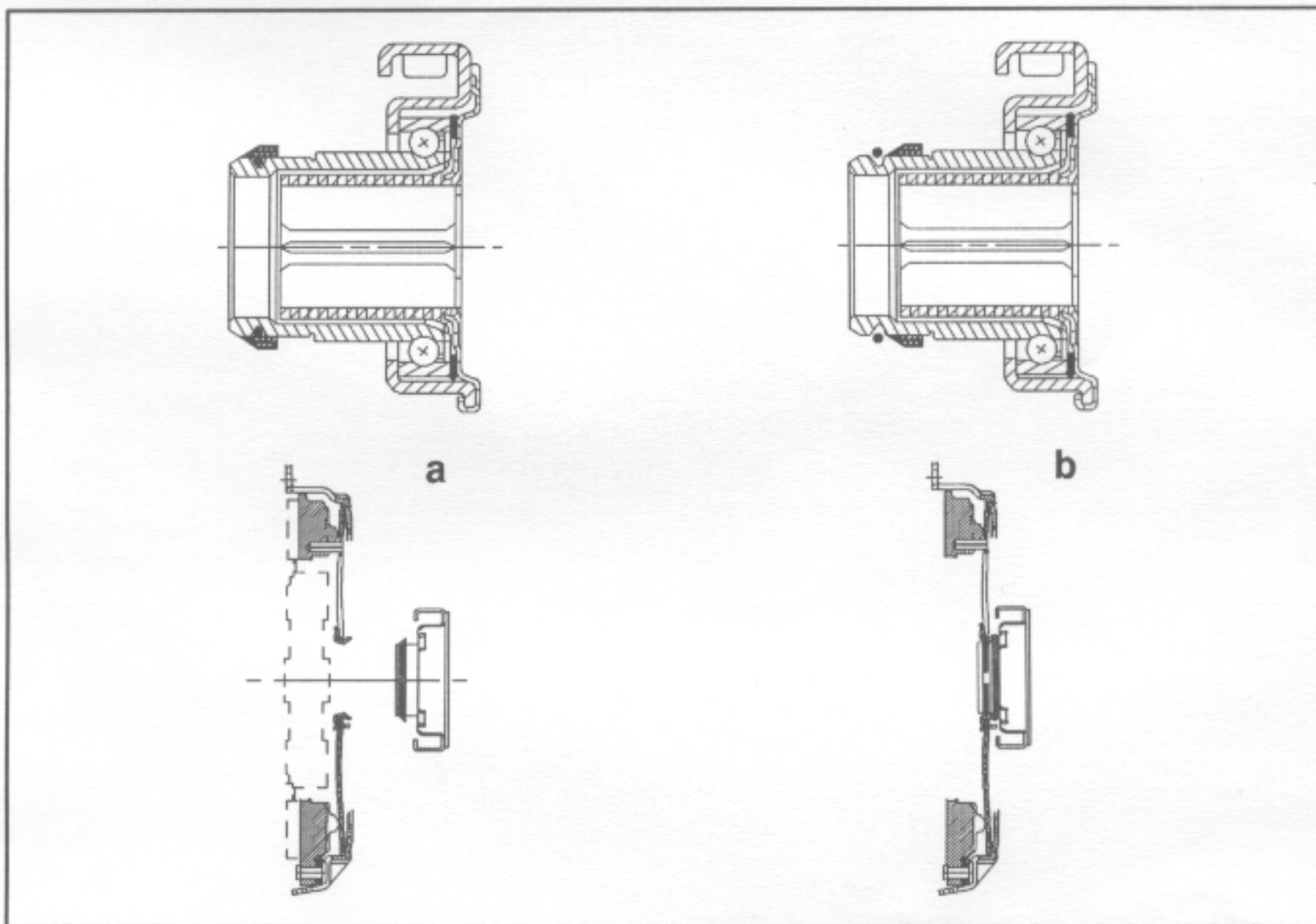

Fig : B2BP01KD

(a) : before clipping.

(b) : after clipping.

3.2 – Refitting

Refit the gearbox (see the relevant operation).

Relocate the engine-gearbox assembly (see the relevant operation).